



ETA-Danmark A/S
Göteborg Plads 1
DK-2150 Nordhavn
Tel. +45 72 24 59 00
Internet www.etadanmark.dk

Authorised and notified
according to Article 29 of the
Regulation (EU)
No 305/2011 of the European
Parliament and of the Council
of 9 March 2011

MEMBER OF EOTA



European Technical Assessment ETA-21/0044 of 2021/01-01

I General Part

Technical Assessment Body issuing the ETA and designated according to Article 29 of the Regulation (EU) No 305/2011: ETA-Danmark A/S

Trade name of the construction product:

Protecta Interior Paint FR-1 Wall System

Product family to which the above construction product belongs:

Internal Partition Kits For Use As
Non-Loadbearing Walls

Manufacturer:

Polyseam Ltd
15 St Andrews Road
Huddersfield
West Yorkshire
HD1 6SB
UK

Manufacturing plant:

Polyseam Ltd
15 St Andrews Road
Huddersfield
West Yorkshire
HD1 6SB
UK

This European Technical Assessment contains:

11 pages including 1 annex which form an
integral part of the document

This European Technical Assessment is issued in accordance with Regulation (EU) No 305/2011, on the basis

EAD 210005-00-0505 for Internal partition kits for
use as non-loadbearing walls

This version replaces:

-

Translations of this European Technical Assessment in other languages shall fully correspond to the original issued document and should be identified as such.

Communication of this European Technical Assessment, including transmission by electronic means, shall be in full. However, partial reproduction may be made, with the written consent of the issuing Technical Assessment Body. Any partial reproduction has to be identified as such.

Table of Contents

I.	SPECIFIC PARTS OF THE EUROPEAN TECHNICAL ASSESSMENT	4
1	Technical description of the product.....	4
2	Specification of the intended uses of the product in accordance with the applicable European .Assessment Document (Hereinafter EAD):	5
3	Performance of the product and references to the methods used for its assessment.....	6
4	ASSESSMENT AND VERIFICATION OF CONSTANCY OF PERFORMANCE (HEREINAFTER AVCP) SYSTEM APPLIED, WITH REFERENCE TO ITS LEGAL BASE	7
5	Technical details necessary for the implementation of the AVCP system, as provided for in the applicable EAD	7
	ANNEX A – Resistance to Fire Classification – Protecta Interior Paint FR-1 Wall System.....	8
A.1	Non-loadbearing wall	8
A.1.1	Classification.....	11

I. SPECIFIC PARTS OF THE EUROPEAN TECHNICAL ASSESSMENT

1 Technical description of the product

- 1) Protecta Interior Paint FR-1 Wall System is non-loadbearing wall designed to provide a fire resistance performance.
- 2) The Protecta Interior Paint FR-1 Wall System comprises a stud and perimeter framework of 38 x 63 mm C16 European Redwood (EN 1912: 2004), faced on both sides with 1 layer of precoated, 12 mm Class E1 particleboard (EN 312: 2010) with a density of 650 kg/m³ min. The studs are positioned at 600 mm centres, with noggins at a height of 2400 mm. The boards are fixed to the studs, perimeter frame and noggins 15 mm from the board edges and at 200 mm centres. The particleboard faces of the partition are precoated on the outward facing side with 220 microns (WFT)/ 305g/m² dry weight of Protecta Interior Paint FR-1, applied by roller. The edges of the partition are sealed with a 5 mm bead of Protect FR Acrylic sealant.
- 3) Polyseam Ltd submitted a written declaration that Protecta Interior Paint FR-1 does not contain substances which have to be classified as dangerous according to Directive 67/548/EEC and Regulation (EC) No 1272/2008 and listed in the "Indicative list on dangerous substances" of the EGDS - taking into account the installation conditions of the construction product and the release scenarios resulting from there.

The particle board (class EN312 P2) is EN120 class E1 and will not exceed the maximum formaldehyde content allowed for that class (≤ 8 mg/100g oven dry board).

In addition to the specific clauses relating to dangerous substances contained in this European technical Assessment, there may be other requirements applicable to the products falling within its scope (e.g. transposed European legislation and national laws, regulations and administrative provisions). In order to meet the provisions of the Construction Products Regulation, these requirements need also to be complied with, when and where they apply.

2 Specification of the intended uses of the product in accordance with the applicable European Assessment Document (Hereinafter EAD)

Detailed information and data is given in Annex A.

- 1) The intended use of Protecta Interior Paint FR-1 Wall System is as non-loadbearing fire resisting partitions, to provide compartmentation, mainly for residential buildings, offices and public buildings.
- 2) The Protecta Interior Paint FR-1 Wall System may be used to provide fire resisting, non-loadbearing partition walls at dimensions of up to 4 m high and of unrestricted length. The partition shall be fixed to a rigid construction classified to EN 13501-2 for at least the required fire resistance period.
- 3) The provisions made in this European Technical Assessment are based on an assumed working life of the Protecta Interior Paint FR-1 Wall System of 10 years, provided that the conditions laid down in the product datasheet for the packaging/transport/ storage/installation/use/repair are met. The indications given on the working life cannot be interpreted as a guarantee given by the producer or the Technical Assessment Body but are to be regarded only as a means for choosing the right products in relation to the expected economically reasonable working life of the works.
- 4) Type Z₂: Intended for uses in internal conditions with humidity lower than 85 % RH excluding temperatures below 0°C, without exposure to rain or UV.

3 Performance of the product and references to the methods used for its assessment

Product-type: Partition Kit		Intended use: Non-Loadbearing Wall
Basic requirement for construction work	Essential characteristic	Performance
	Mechanical resistance and stability	
	None	See Safety in use
Safety in case of fire		
	Reaction to fire	B-s1, d0
	Resistance to fire	EI 30
Hygiene, health and environment		
	Water vapour permeability	No performance assessed
	Release of dangerous substances	Declaration of manufacturer
	Water permeability	Not relevant
Safety in use		
	Resistance to horizontal and eccentric loads	No performance assessed
	Safety against personal injuries by contact	No sharp and cutting edges No risk of abrasion or cutting people by nature of surfaces
Protection against noise		
	Airborne sound insulation	No performance assessed
	Sound absorption	No performance assessed
Energy economy and heat retention		
	Thermal resistance	No performance assessed
	Thermal inertia	No performance assessed
General aspects relating to fitness for use		
	Robustness and rigidity – Resistance to dynamic loads – Resistance to eccentric vertical Loads – Resistance to point loads – Rigidity of partitions for ceramic tiling	Use category I, II, III and IV No performance assessed No performance assessed No performance assessed
	Resistance to deterioration – physical agents – chemical agents – biological agents	No performance assessed
	Identification	Fingerprint held on confidential file

4 ASSESSMENT AND VERIFICATION OF CONSTANCY OF PERFORMANCE (HEREINAFTER AVCP) SYSTEM APPLIED, WITH REFERENCE TO ITS LEGAL BASE

According to Annex V of Regulation (EU) No 305/2011 of the European Parliament and of the Council of 9 March 2011 and according to the decision 98/213/EC in compliance with 210005-00-0505 Internal partition kits for use as non-loadbearing walls the system 1 of Assessment and Verification of Constancy of Performance applies.

5 Technical details necessary for the implementation of the AVCP system, as provided for in the applicable EAD

Technical details necessary for the implementation of the AVCP system are laid down in the control plan deposited at ETA-Danmark A/S prior to CE marking

Issued in Copenhagen on 2021-01-01 by



Thomas Bruun

Managing Director, ETA-Danmark

ANNEX A – Resistance to Fire Classification – Protecta Interior Paint FR-1 Wall System

A.1 Non-loadbearing wall

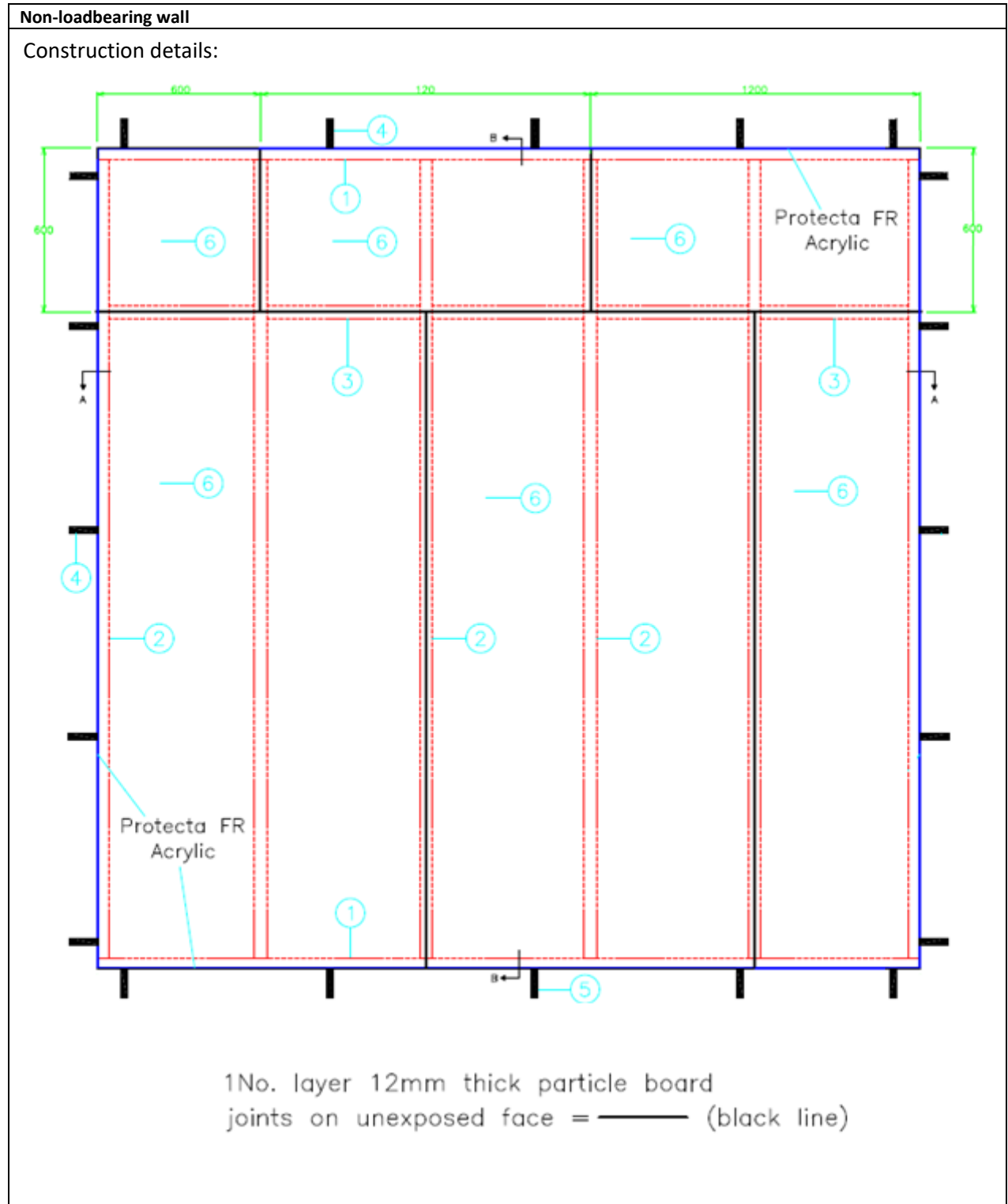

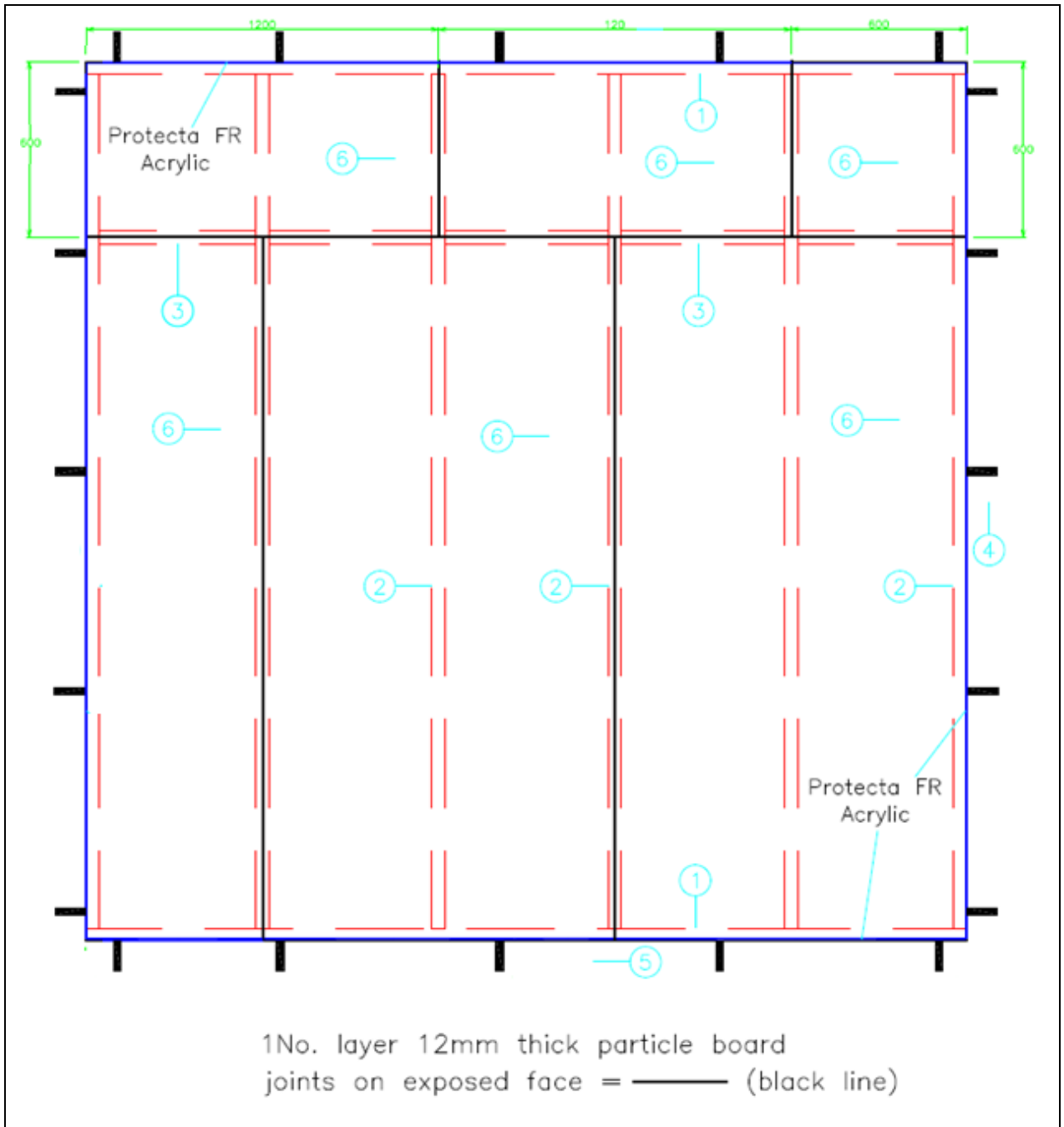

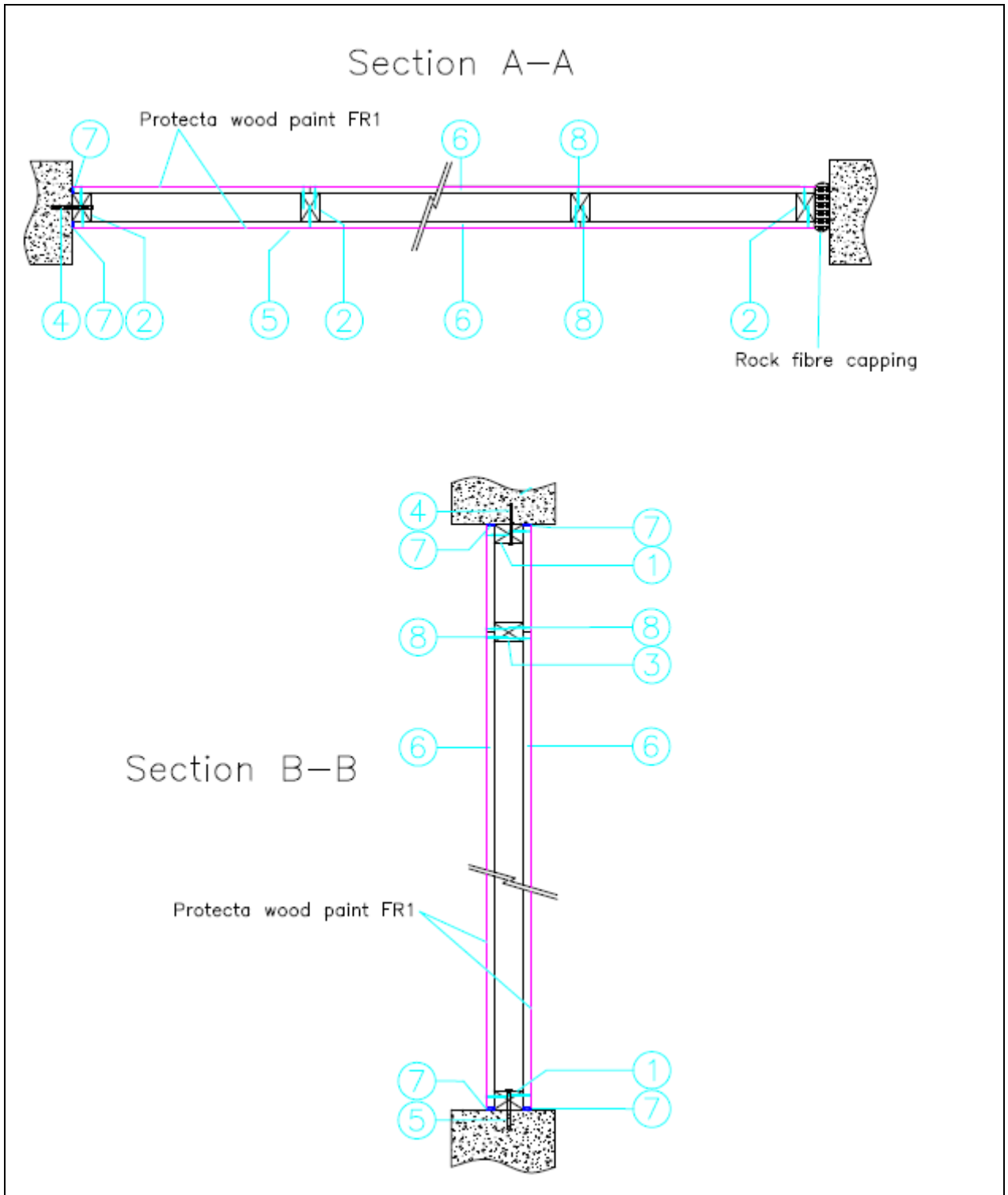

Internal framework

		Description	Dimensions (mm)	Key to figures
Head and base track		C16 European Redwood (EN 1912 2004)	38 wide x 63 deep	1
Studs – fitted at nominally 600mm centres		C16 European Redwood (EN 1912 2004) fixed to the head, base track and noggins with Ø5 x 80mm long steel wood screws (EN 14592 2008 +A1 2012)	38 wide x 63 deep	2
Noggins fitted 600mm down from the head		C16 European Redwood (EN 1912 2004)	38 wide x 63 deep	3
Fixing details	Head track and left side end stud	Masonry fixings 100mm from the ends and at nominally 750mm centres	80 long	4
	Base track	Masonry fixings 100mm from the ends and at nominally 750mm centres	100 long	5

Cladding – see figures 1 and 2 of appendix 1 for board joints

	Description	Dimensions (mm)	Density (kg/m ³)	Moisture content	Key to figures
Board – both faces	1 No. layer of Kronospan P2 E1 particleboard (EN 312 2010) with a 220 micron** (WFT) coating on the outer faces, 305g/m ² dry weight, (applied before assembly) of Protecta wood paint FR1	12 thick	650*	8.55%	6
Perimeter sealing	Protecta FR Acrylic sealing the board edges to the restraint frame	5 wide x 12 deep	-	-	7
Fixings	Steel wood screws (EN 14592 2008 +A1 2012) fitted 15mm from board edges at 200mm centres	Ø3.5 x 30 long	-	-	8

A.1.1 Fire Resistance Classification

Classification	EI 30
-----------------------	--------------

A.1.2 Use category

I, II, III and IV
